

Self-drilling screws

with european technical assessment, for attachment on trapezoid sheet according to approval ETA-10/0200, galvanised

| Sheet metal thread G [mm] | Length L [mm] | Screw head diameter [mm] | Spanner width [mm] | Part no. | Sales unit | Pack unit |
|---------------------------|---------------|--------------------------|--------------------|----------|------------|-----------|
| 4.2 | 16 | 9 | 7 | 147874 | 1,000 | Pieces |
| 4.8 | 19 | 10 | 8 | 147875 | | |

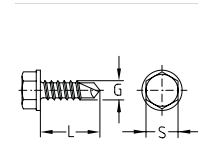

Self-drilling screw, chipless, form K

according to DIN EN 12237, combination drive with hexagon and slot, for connecting thin-walled sheet steel components and for the attachment of air pipes, ducts, spiral-seam pipes, **sheet thickness ≤ 1 mm**, without pre-drilling, galvanised

| Sheet metal thread G [mm] | Length L [mm] | Screw head diameter [mm] | Spanner width [mm] | Part no. | Sales unit | Pack unit |
|---------------------------|---------------|--------------------------|--------------------|----------|------------|-----------|
| 4.2 | 13 | 8.5 | 7 | 176206 | 500 | Pieces |

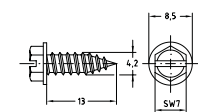

Blind rivets

Application

- For the attachment of duct fixing angles and brackets on air ducts and spiral-seam tubes respectively

Your advantages

- Blind rivet with large surface in order to secure various materials
- No surface damaging after riveting
- No loosening by dynamic influences (vibration resistant)
- Good behaviour at temperature fluctuations
- High-quality, simple and quick mounting

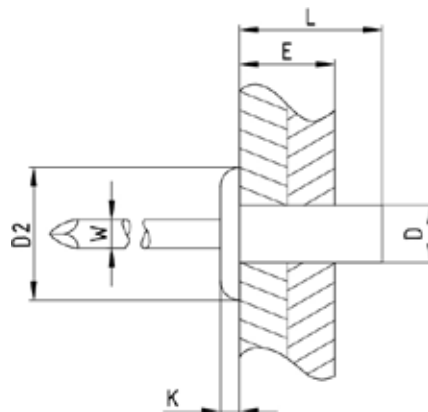

| Material sleeve | Material mandrel | Dimensions [mm] | | | | | | Part no. | Sales unit | Pack unit |
|-----------------|------------------|-----------------|-----|---------|------|-----|------|----------|------------|-----------|
| | | D | D2 | E | L | K | W | | | |
| Aluminium | Steel | 3.2 | 6.2 | 3.5 - 5 | 9.5 | 1 | 1.65 | 140665 | 500 | Pieces |
| | | 4 | 7.9 | 5 - 6.5 | 11 | 1.2 | 2.2 | 140927 | | |
| | | 4.8 | 9.3 | 8 - 9.5 | 14.5 | 1.5 | 2.65 | 140928 | | |