

Single bossed clamps

with connection socket and DÄMMGULAST® yellow, galvanised

Application

- Suitable combination for pipelines with dynamic loads with expansion points
- Suitable for fixings in shipbuilding and industrial areas
- Specially suitable for standing fixings
- Suitable for fixings in air-conditioning, ventilation and sanitary areas
- For indoor use

Your advantages

- Proven, two-piece single bossed clamp in heavy-duty design
- For bending-resistant fastening at greater distances from the building structure
- Ideal combination when used with pipe nipple and base plate or socket adapter
- DÄMMGULAST® vibration control lining with yellow identification stripe: average sound level improvement up to 22 dB(A)



- This product is awarded with the „Gütezeichen Rohrbefestigung“ (quality mark of pipe support) and is submitted to controls according to RAL-GZ 655-B



Features



Size	Max. recommended load [N]
½" - 2"	1,700
70 - 83 mm	2,200
3" - 6"	2,900
170 - 200 mm	3,500

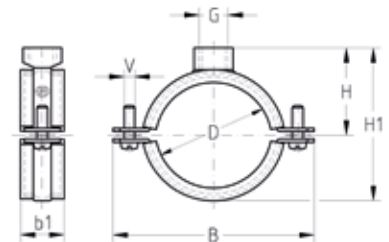

Connecting thread G	Size		Clamping range [mm]	Dimensions [mm]				Part no.	Sales unit	Pack unit		
	[inch]	[mm]		b1	B	H	H1				V	
½"	¾"	57	21 - 26	23	71	47.5	70	M6 x 20	154945	100	Pieces	
			26 - 30		75	49.5	74		154946			
			31 - 38		81	52.5	80		M6 x 25			154947
			40 - 47		91	57.5	90					154948
			48 - 54		100	61.5	98		154949			
			54 - 60		105	64	103		154950			
	2"	83	60 - 66	28	111	67	109	M8 x 35	154951	50		
			68 - 73		126	71.5	118		154816			
			73 - 80		131	74	123		154817			
			82 - 87		142	79	133		154818			
			87 - 94		146	81	137		154819			
			99 - 104		157	86.5	148		154820			
4"	110	105 - 112	28	166	91	157	M8 x 40	154821	25			
		112 - 118		172	94	163		154822				
		122 - 128		182	99	173		154823				
		132 - 137		191	103.5	182		154824				
		137 - 142		196	106	187		154825				
		142 - 148		202	109	193		154826				
5"	125	149 - 156	28	210	113	201	M8 x 40	154827	25			
		159 - 164		218	117	209		154828				
		164 - 169		223	119.5	214		154829				
		177 - 183		235	126	227		154831				
		197 - 203		256	136	247		154832				



Single bossed clamps can be produced in all other pipe sizes and types according to customer specifications.

Single bossed clamps

with connection socket and DÄMMGULAST® yellow, galvanised

Connecting thread G	Size		Clamping range [mm]	Dimensions [mm]					Part no.	Sales unit	Pack unit	
	[inch]	[mm]		b1	B	H	H1	V				
¾"	2"		60 - 66	23	111	71	113	M6 x 25	154954	50	Pieces	
		70	68 - 73	28	126	75.5	122	M8 x 35	154833			
	2½"		73 - 80		131	78	127		154834			
		83	82 - 87		142	83	137		154835			
	3"		87 - 94		146	85	141	M8 x 40	154836			
		102	99 - 104		157	90.5	152		154837			
		110	105 - 112		166	95	161		154838			
			112 - 118		172	98	167		154839			
	4"		122 - 128		182	103	177		154840			
		133	132 - 137		191	107.5	186		154841			
		5"		137 - 142		196	110	191				154842
			144	142 - 148		202	113	197				154843
			149 - 156		210	117	205		154844			
			159 - 164		218	121	213		154845			
		6"		164 - 169		223	123.5	218				154846
			170	169 - 172		225	124.5	220				154847
	180		177 - 183		235	130	231		154848			
	200		197 - 203		256	140	251		154849			



Single bossed clamps can be produced in all other pipe sizes and types according to customer specifications.