

Single bossed clamps

with connecting socket, without lining, galvanised

Application

- Applicable as a pipeline anchor point
- Suitable for fixings in shipbuilding and industrial areas
- Suitable for fixings in air-conditioning, ventilation and sanitary areas
- For indoor use

Your advantages

- Proven, two-piece single bossed clamp in heavy-duty design
- For bending-resistant fastening at greater distances from the building structure
- Ideal combination when used with pipe nipple and base plate or socket adapter
- This product is awarded with the „Gütezeichen Rohrbefestigung“ (quality mark of pipe support) and is submitted to controls according to RAL-GZ 655-B



Mounting as anchor assembly with pipe nipple and single bossed clamp with connecting socket



Features



Size	Max. recommended load [N]
1" - 70 mm	1,900
2½" - 6"	4,400

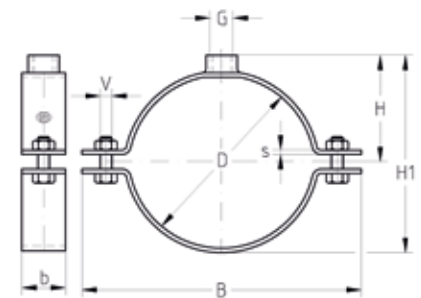

Connecting thread G	Size		Clamping range [mm]	Dimensions [mm]					Part no.	Sales unit	Pack unit
	[inch]	[mm]		b	B	H	H1	V			
½"	1"	31 - 37	20	71	47.5	70	M6 x 20	154978	100	Pieces	
		40		75	49.5	74		154979			
	1¼"	42.4	25	81	52.5	80	M6 x 25	154980	50		
		47 - 52		87	55	85		154981			
	1½"	57	25	91	57.5	90	M8 x 35	154982	50		
		53 - 57		100	61.5	98		154983			
	2"	70	25	105	64	103	M8 x 40	154984	50		
		72 - 78		120	68.5	112		154931			
	2½"	83	25	126	71.5	118	M8 x 40	154932	50		
		85 - 90		131	74	123		154933			
	3"	102	25	146	81	137	M8 x 40	154934	50		
		108 - 115		157	86.5	148		154935			
4"	122	25	166	91	157	M8 x 40	159190	50			
	125 - 130		172	94	163		154936				
5"	133 - 140	25	182	99	173	M8 x 40	154937	50			
	142 - 148		191	103.5	182		159191				
6"	152	25	196	106	187	M8 x 40	159192	50			
	148 - 153		202	109	193		154938				
6"	160	25	210	113	201	M8 x 40	154939	50			
	154 - 160										



Single bossed clamps can be produced in all other pipe sizes and types according to customer specifications.