

Duct clamps

without lining, stainless steel

Application

- For attachment of spiral-seam pipes

Your advantages

- Manufactured to suit air duct dimensions
- The 2 locking screws allow adjustment to accommodate a greater variation in pipe diameter



Features



Max. recommended load [N] 500

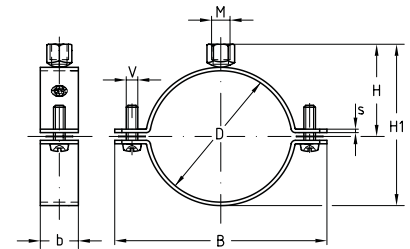

Nominal size DN	Connecting thread	Material	Dimensions [mm]						Part no.	Sales unit	Pack unit
			B	H	H1	b	s	V			
50	M8	V2A	95	39	66	25	1.5	M6	115606	1	Pieces
63			108	45	79				115612		
71			116	49	87				115618		
80			125	54	96				115627		
90			135	59	106				115633		
100			146	64	117				115506		
112			158	70	129				115512		
125			171	77	142				115521		
140			186	84	157				115533		
150			196	89	167				115542		
160			206	94	177				115548		
180			226	107	197				115555		
200			246	114	217				115560		
224			272	131	247				115567		
250			298	144	273				115576		
280			328	159	303				115582		
300			349	170	324				115585		
315			364	177	339				115594		
355	404	197	379	115600							
400	449	220	424	115603							
450	M10	V2A	515	245	474	2.5	M8	115456			
500			565	270	524			115461			
560			625	300	584			115464			
600			665	320	624			115467			
630			696	335	655	3	115470				
710			776	375	735		115476				
800			866	420	825		115479				

