

Mounting angle 90°

similar to DIN 1029, with oblong hole, galvanised

Application

- Solid fixing element for construction of pre-wall installations and shelves as well as for channel constructions for attachments of pipelines and air ducts without welding
- Also applicable for direct mounting on bulkheads, ceilings or floors

Your advantages

- Multi-use mounting angle
- Rational mounting via ribbed screws

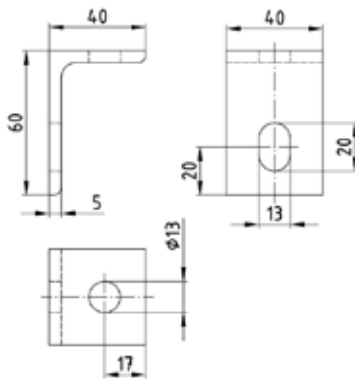

Features



Design	Length [mm]	Width [mm]	Thickness [mm]	Part no.	Sales unit	Pack unit
60 x 40 x 5 mm	60	40	5	143713	1	Pieces