

Self-drilling screws

with european technical assessment, for attachment on trapezoid sheet according to approval ETA-10/0200, galvanised

Sheet metal thread G [mm]	Length L [mm]	Screw head diameter [mm]	Spanner width [mm]	Part no.	Sales unit	Pack unit
4.2	16	9	7	147874	1,000	Pieces
4.8	19	10	8	147875		

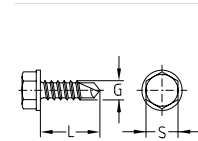

Self-drilling screw, chipless, form K

according to DIN EN 12237, combination drive with hexagon and slot, for connecting thin-walled sheet steel components and for the attachment of air pipes, ducts, spiral-seam pipes, **sheet thickness ≤ 1 mm**, without pre-drilling, galvanised

Sheet metal thread G [mm]	Length L [mm]	Screw head diameter [mm]	Spanner width [mm]	Part no.	Sales unit	Pack unit
4.2	13	8.5	7	176206	500	Pieces

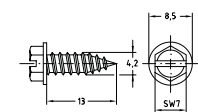

Blind rivets

Application

- For the attachment of duct fixing angles and brackets on air ducts and spiral-seam tubes respectively

Your advantages

- Blind rivet with large surface in order to secure various materials
- No surface damaging after riveting
- No loosening by dynamic influences (vibration resistant)
- Good behaviour at temperature fluctuations
- High-quality, simple and quick mounting

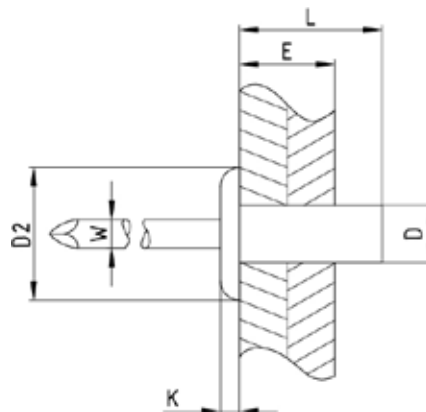

Material sleeve	Material mandrel	Dimensions [mm]						Part no.	Sales unit	Pack unit
		D	D2	E	L	K	W			
Aluminium	Steel	3.2	6.2	3.5 - 5	9.5	1	1.65	140665	500	Pieces
		4	7.9	5 - 6.5	11	1.2	2.2	140927		
		4.8	9.3	8 - 9.5	14.5	1.5	2.65	140928		